

U-STANDARDS BASE:



FEATURES:

- Passive Base - Spring Feature is Derived from Board Only
- Available in 6 Powder Coated Finishes
- Available in 3 Thermo Plastic Coated Finishes
- Weight Limit = 250 lbs.
- Available in 6', 8', 10', or 12' Set-Ups
- 2 Hole Drill Pattern 12" on center
- Refer to Board Chart on Pg. 7

Part # DBU12049 (12" U style)
 Part # DBU14049 (14" U style; Also available in .065" #DBU14065)
 Part # DBU18049 (18" U style; Also available in .065" #DBU18065)
 Part # DBU24049 (24" U style; Also available in .065" #DBU24065)

U-Stand sets 4" into the deck.

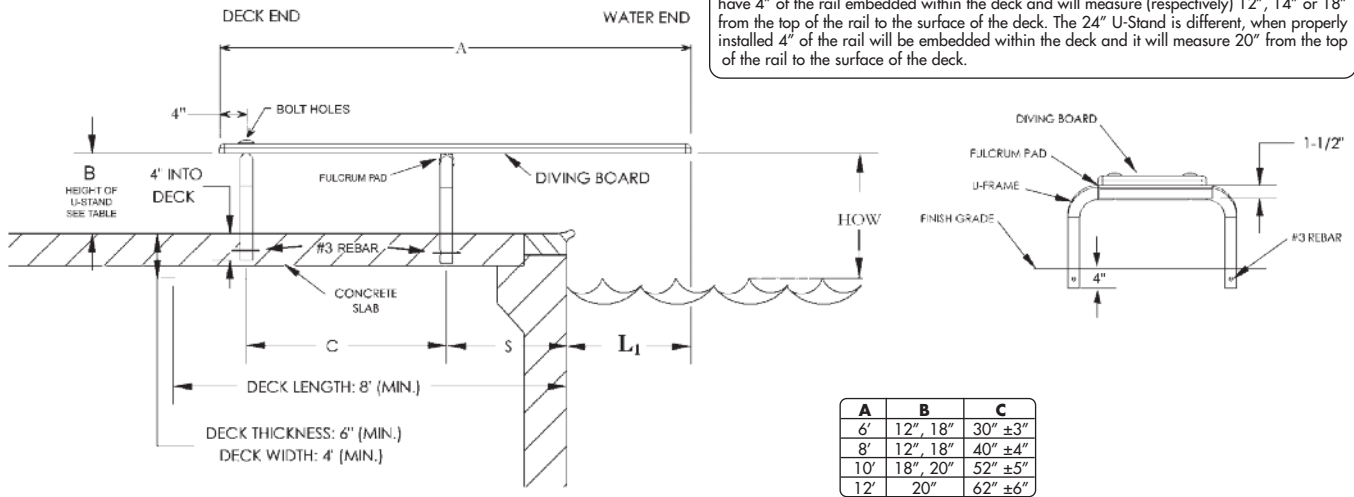

IMPORTANT NOTICE: When properly installed, Inter-Fab's 12", 14", and 18" U-Stands will have 4" of the rail embedded within the deck and will measure (respectively) 12", 14" or 18" from the top of the rail to the surface of the deck. The 24" U-Stand is different, when properly installed 4" of the rail will be embedded within the deck and it will measure 20" from the top of the rail to the surface of the deck.

| A | B | C |
|-----|----------|---------|
| 6' | 12", 18" | 30" ±3" |
| 8' | 12", 18" | 40" ±4" |
| 10' | 18", 20" | 52" ±5" |
| 12' | 20" | 62" ±6" |

IMPORTANT: THESE DIMENSIONS ARE ACCURATE ONLY FOR VERTICAL POOL WALLS, TYPICALLY GUNITE CONSTRUCTION WITH LESS THAN A 3' RADIUS TO THE POOL FLOOR. DUE TO THE VARYING SIZES OF VINYL LINER CONSTRUCTION, IF YOU REQUIRE A JIG PLACEMENT, PLEASE REACH OUT TO OUR CUSTOMER SERVICE TEAM AT LEAST 24 HOURS PRIOR TO INSTALLATION. WE REQUIRE THE DRAWING, SIDE VIEW OF POOL, AND WHICH DIVING SYSTEM YOU WILL BE INSTALLING. EMAIL INFORMATION TO CUSTOMERSERVICE@INTER-FAB.COM

| U-STANDARDS PART # (Note: there are several sizes available for each pool type) | NOMINAL BOARD LENGTH | ANSI/POOL TYPE | DISTANCE FROM WATER'S EDGE TO FORWARD U-STAND (S) | DISTANCE FROM END OF BOARD TO FORWARD U-STAND | MIN. OVERHANG (WA) | MAX HEIGHT OF BOARD ABOVE WATER (HOW) |
|--|----------------------|----------------|--|---|--------------------|---------------------------------------|
| DBU12049 | 6' | I | 18.25" | 36.25" | 18" | 20" |
| DBU12049 | 6' | II | 18.25" | 36.25" | 18" | 20" |
| DBU12049 or DBU14049 or DBU18049 | 6' | III | 12.25" | 36.25" | 24" | 26" |
| DBU12049 or DBU14049 or DBU18049 | 6' | IV | 6.25" | 36.25" | 30" | 30" |
| DBU12049 or DBU14049 or DBU18049 | 6' | V | Not recommended. Call customer service for more information. | | | |
| | 8' | I | NOT ALLOWED | | | |
| DBU12049 | 8' | II | 32" | 50" | 18" | 20" |
| DBU12049 or DBU14049 or DBU18049 | 8' | III | 26" | 50" | 24" | 26" |
| DBU12049 or DBU14049 or DBU18049 | 8' | IV | 20" | 50" | 30" | 30" |
| DBU12049 or DBU14049 or DBU18049 | 8' | V | 14" | 50" | 36" | 40" |
| | 10' | I | NOT ALLOWED | | | |
| | 10' | II | NOT ALLOWED | | | |
| DBU18049 or DBU24049 | 10' | III | 37.5" | 61.5" | 24" | 26" |
| DBU18049 or DBU24049 | 10' | IV | 31.5" | 61.5" | 30" | 30" |
| DBU18049 or DBU24049 | 10' | V | 25.5" | 61.5" | 36" | 40" |
| | 12' | I | NOT ALLOWED | | | |
| | 12' | II | NOT ALLOWED | | | |
| | 12' | III | NOT ALLOWED | | | |
| | 12' | IV | NOT ALLOWED | | | |
| DBU24 | 12' | V | 40" | 76" | 36" | 40" |

U-STANDARDS BASE (DBU12049):

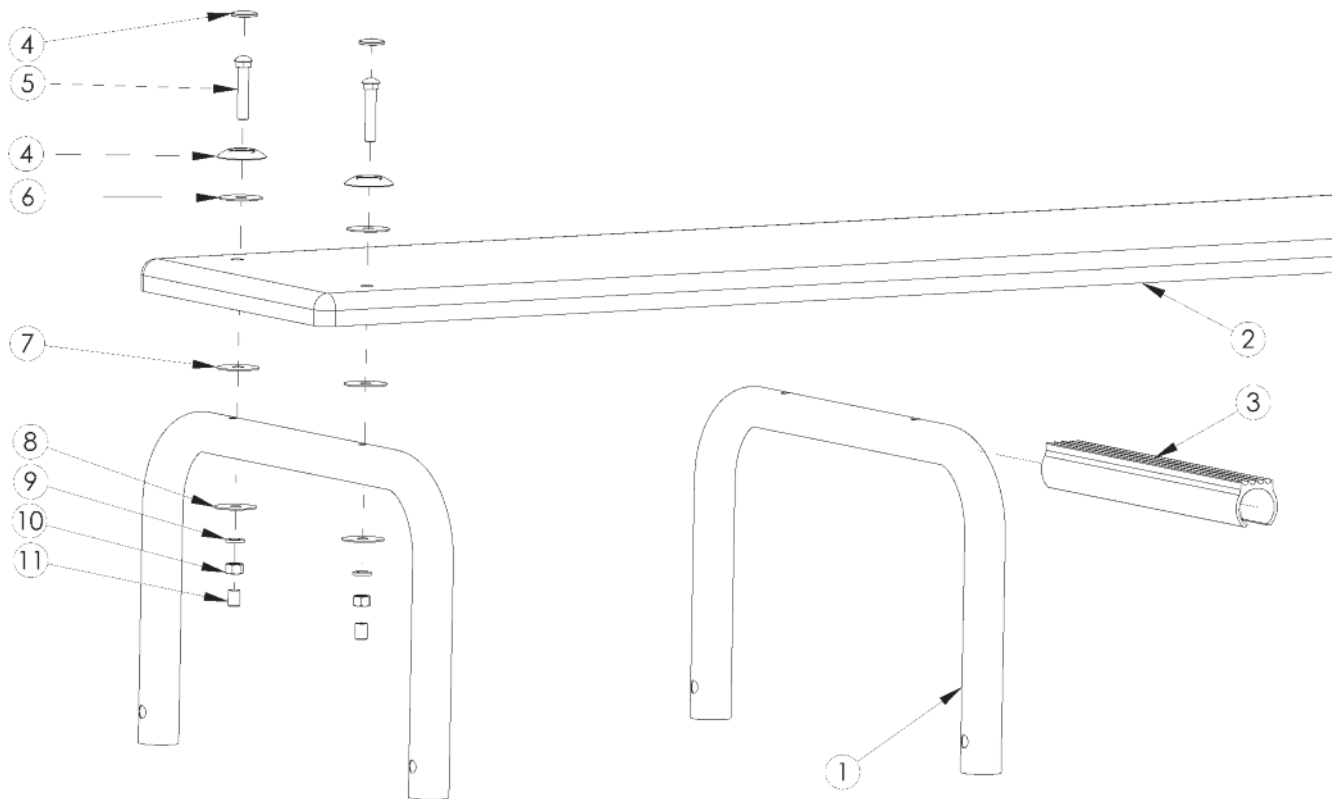

| DRAWING REPRESENTS THE FOLLOWING PART NUMBERS: | |
|--|------------------|
| | DBU12049 (shown) |
| | DBU14049 |
| | DBU14065 |
| | DBU18049 |
| | DBU18065 |
| | DBU24049 |
| | DBU24065 |

Check your local electrical code for bonding requirements.

| ITEM # | COMPONENT | DESCRIPTION | KITS – QTY. | |
|--------|-----------------|--|-------------|---------|
| | | | DB-TB-M | U-STAND |
| 1 | DBU12049 | 12" U Style Diving Standards | | 2 |
| 2 | DB6WW | 6' Duro-Beam White w/White Top Tread & Hdw Kit | | 1 |
| 3 | FC | Fulcrum Cover For U-Standard Base | | 1 |
| 4 | H-WHT WAS/CAP | I.F. White Washer/Cap | 2 | |
| 5 | H-SS 5 C BOLT | 1/2-13 x 5 Carriage Bolt S.S. | 2 | |
| 6 | H-1/2 BLK WASH | 1/2 x 2" Black Rubber Washer | 2 | |
| 7 | H-1/2 RED WASH | 1/2 x 2" Red Rubber Washer | 2 | |
| 8 | H-SS 1/2 F WAS | 1/2 USS Flat Washer S.S. | 2 | |
| 9 | H-SS 1/2 LOC WA | 1/2 Lock Washer S.S. | 2 | |
| 10 | H-SS 1/2 H NUT | 1/2" - 13 Hex Finish Nut S.S. | 2 | |
| 11 | H-1-1/2 WHT CAP | .750 x 1-1/2 White UV Nut Cap | 2 | |
| 12* | H-ANTI-SEIZE | Packet of Anti Seize Lubricant (not shown) | 1 | |

DB-TB-M:
Board to Base Mounting Hardware

* not pictured

NOTES:

DB6WW diving board shown in exploded view for illustration purposes. Must be purchased separately. Other diving board options available. Protective Caps for bolts available in White only.